

## **How to set up and operate a mist net with ECOTONE Alu Poles GUIDE BOOK**

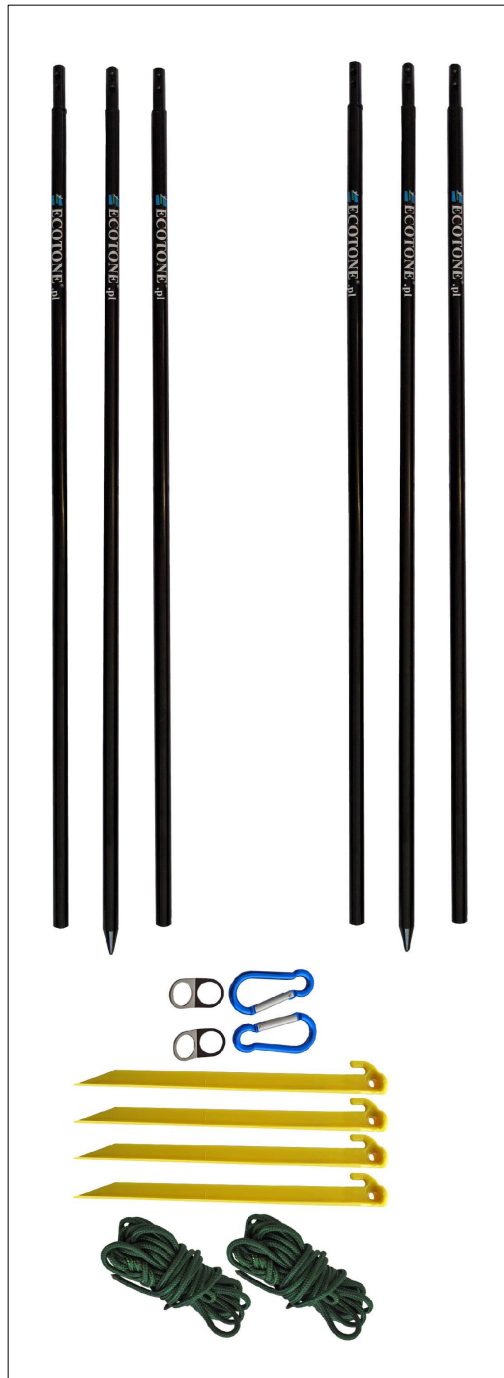

Start from preparing a low poles – each from 2 segments (1x bottom + 1 x top section) than put on the net in order and prepare guiding ropes using Ecotone mounting set for aluminum poles (see picture below). Stretch properly.

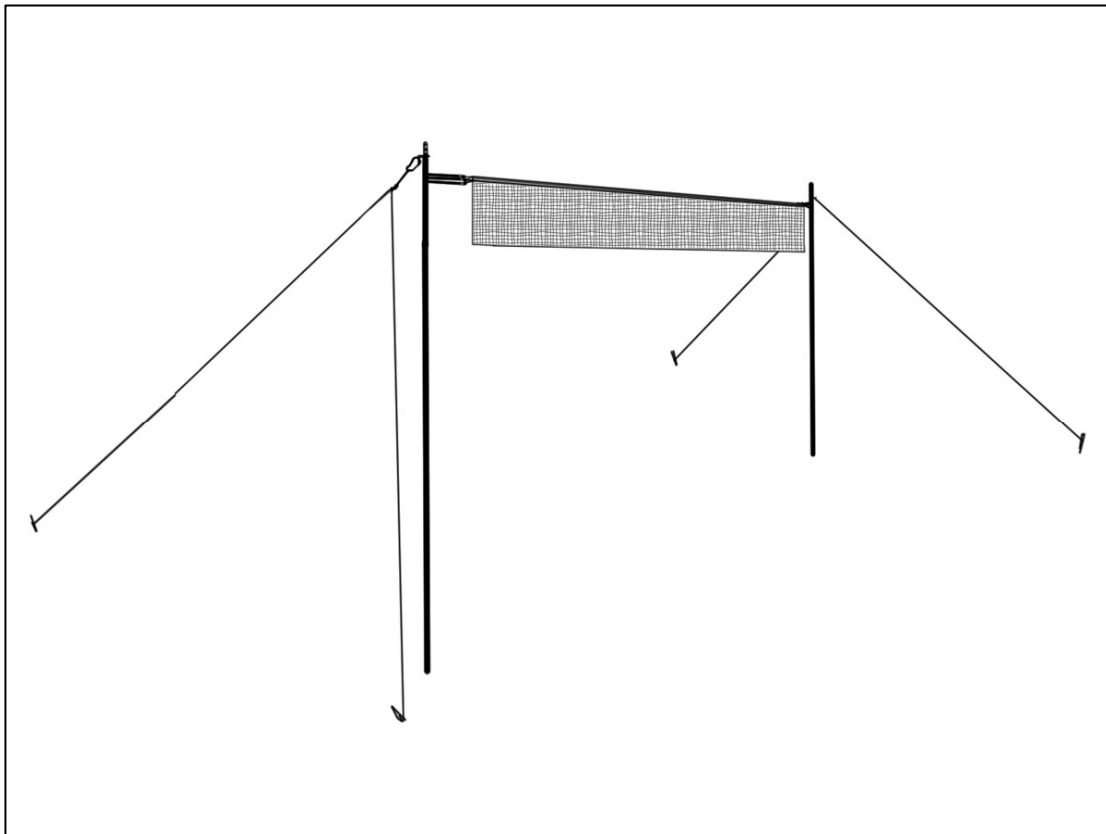

Prepare a top section and attach a rope with a carabiner for easy pull up and pull down the net in the way shown on the picture.

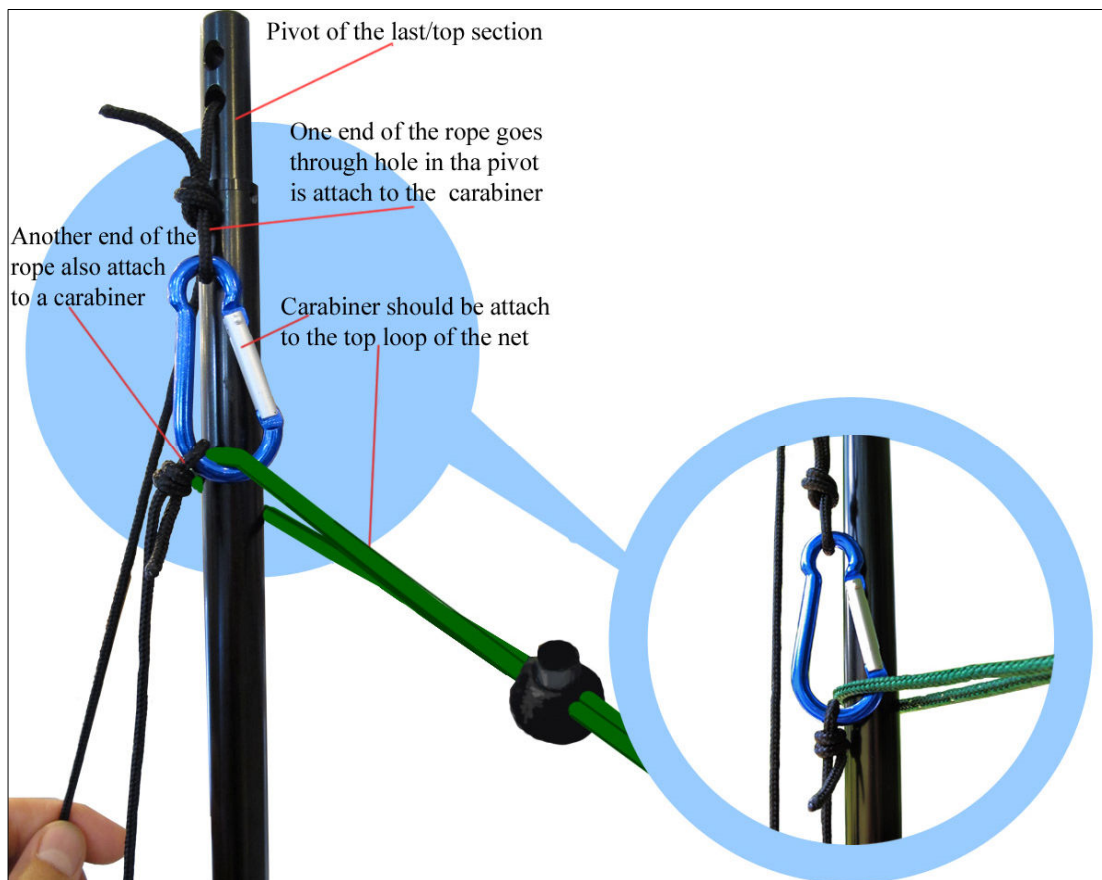



Set the rest of the pole from as many segments as you wish, keeping the section prepared earlier on the top. Put it all together (see picture below).

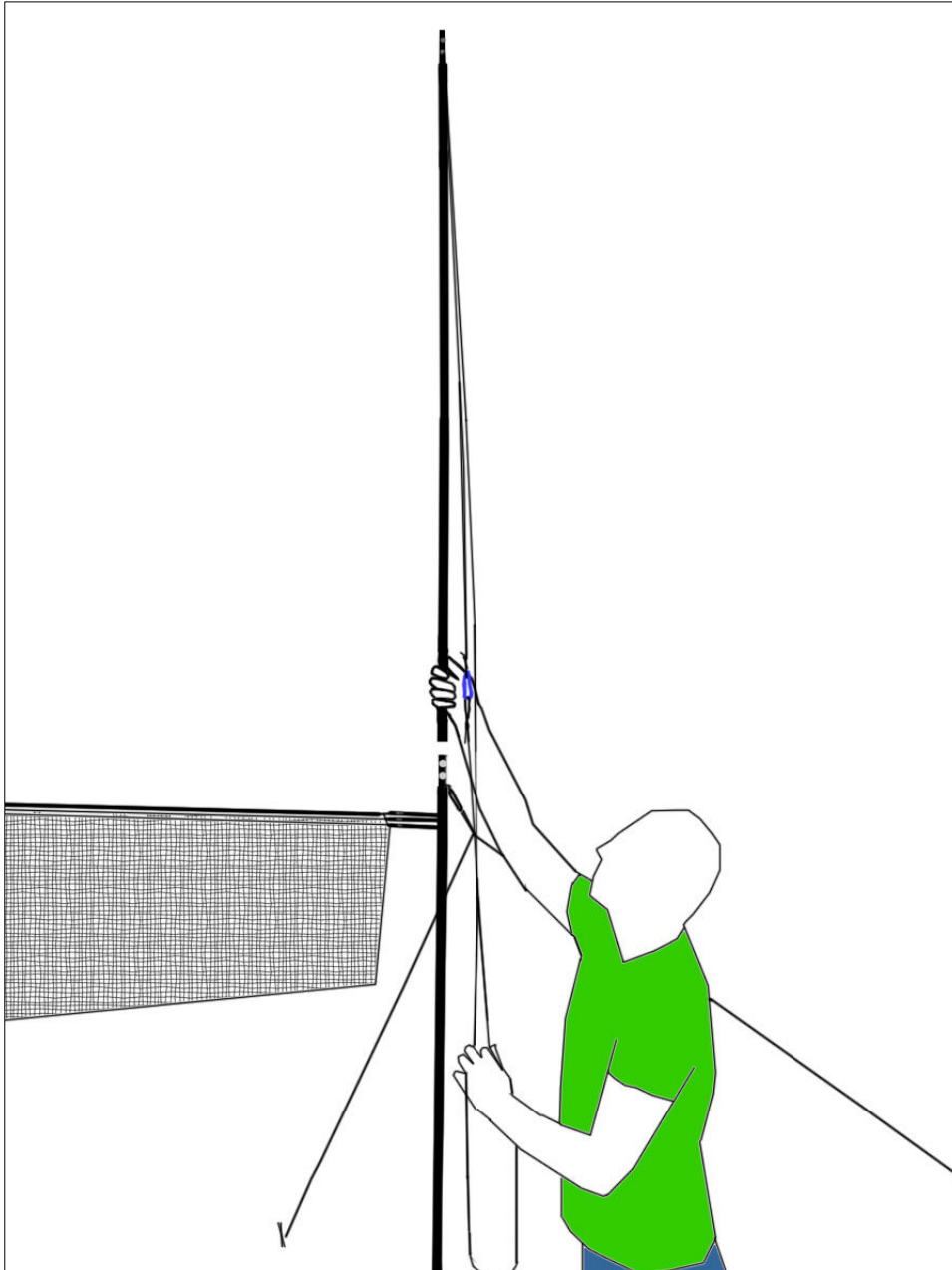



# ECOTONE

Unhook guiding rope and move loops of the net on the upper section of the pole. Then hook back the rope.

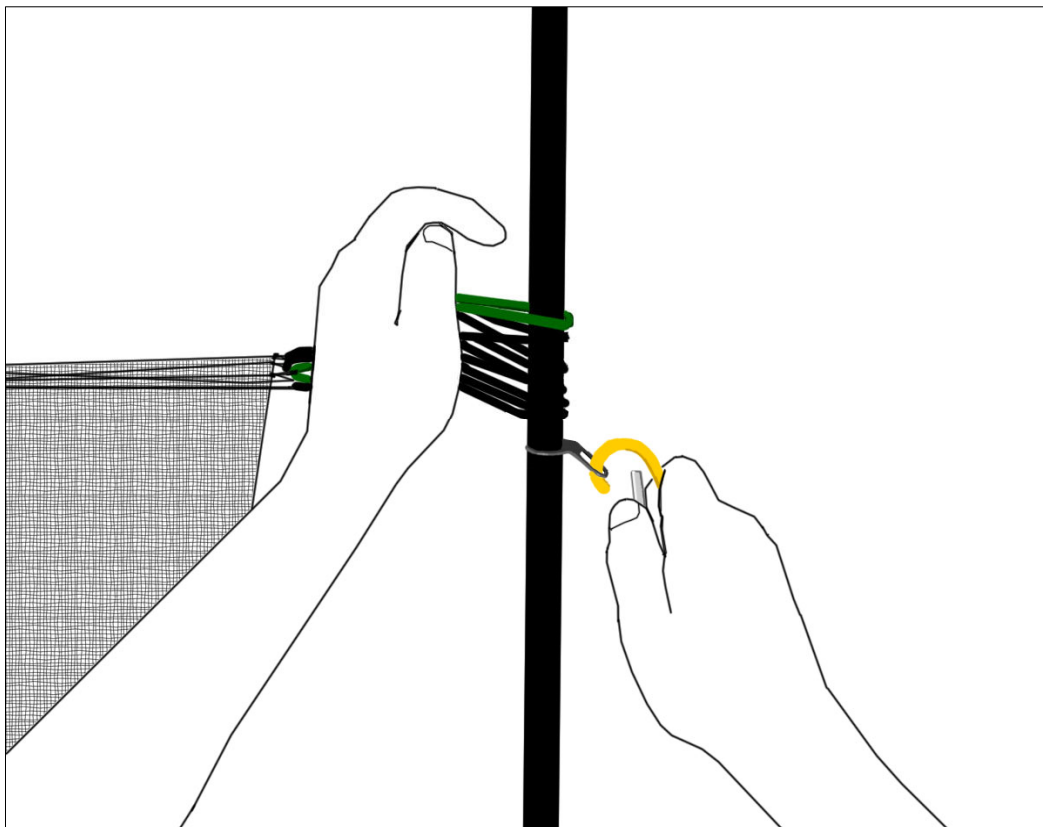
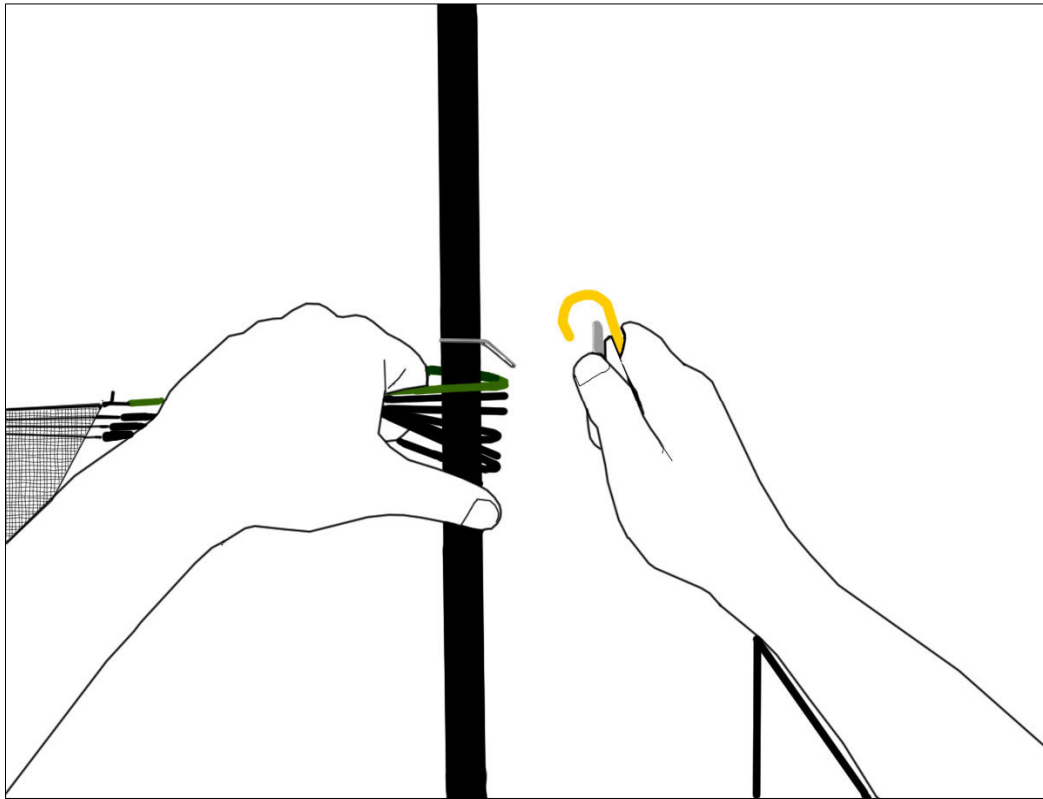

Hook the top loop to the carabiner.

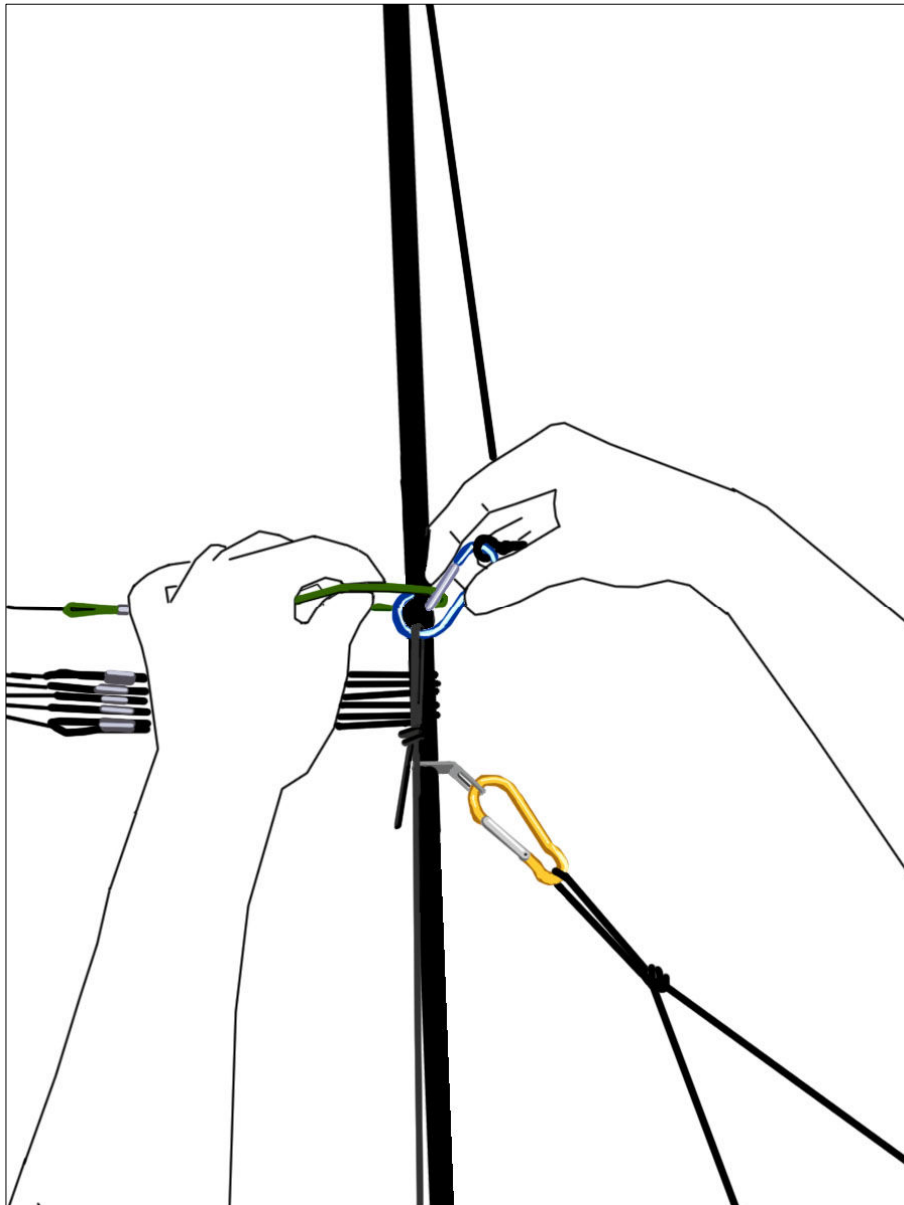

Now you can easily pull up and down the net.

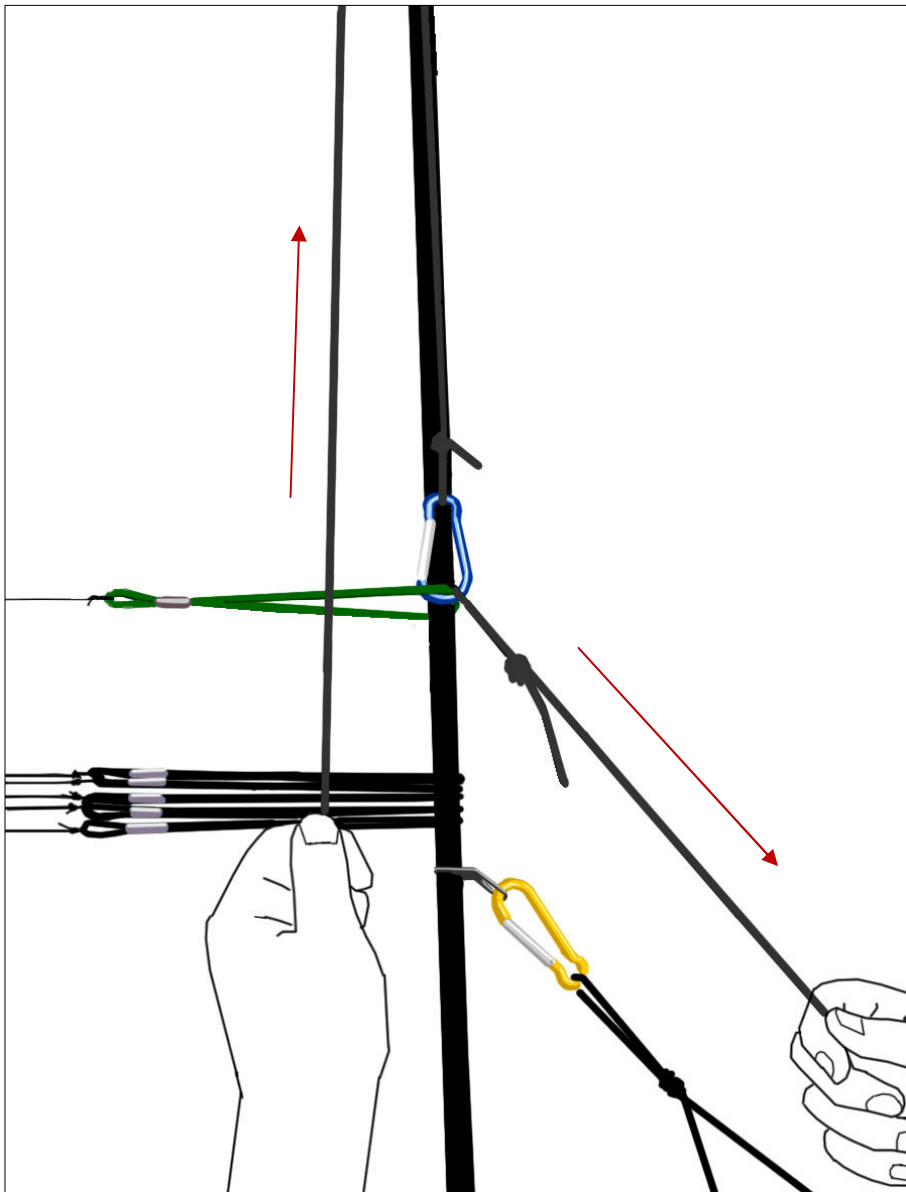

When there is no necessity to move the net up/down these rope can be used as an additional guiding rope / extra stabilization which is useful especially in case of very high setup.

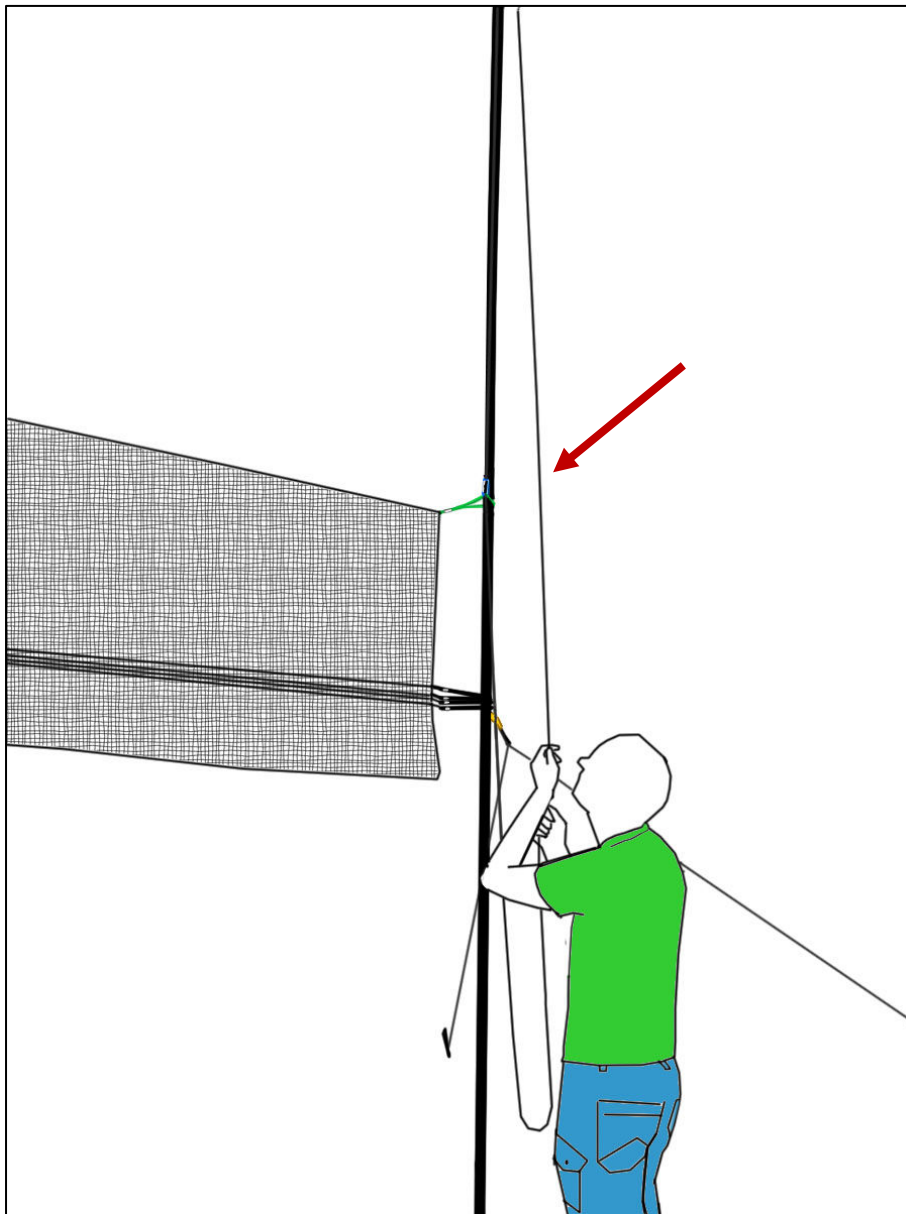

**Ecotone Office**  
**Stryjska 24, 81-506 Gdynia, POLAND**  
**office@ecotone.pl, +48/58 552 33 73**